

- 1
- 2
- 3
- 4
- 5
- 6
- 7
- 8
- 9
- 10
- 11
- 12
- 13
- 14
- 15
- 16
- 17
- 18
- 19

MATERIAL

Aluminium, matte finish.
AISI 304 stainless steel screws and nuts.

STANDARD EXECUTIONS

- **GN 135-B-B**: for round tubes.
- **GN 135-B-V**: for round and square tubes.
- **GN 135-V-V**: for square tubes.
- **GN 135-V-B**: for square and round tubes

Surface finish index:

- **BL**: natural colour.
- **SW**: epoxy resin coating resistant to UV rays, RAL 9005 black colour.

FEATURES AND APPLICATIONS

The assembly holes of GN 135 connecting clamps allow an excellent match with tubes GN 990 (see page 1368).

Within the same nominal size the connecting clamp may be supplied with the holes d1 and d2, square holes s1 and s2 or in combination with round and square holes of unequal dimensions.

The clamping screw d3 may be replaced by clamping kit GN 911 (see page 1372).

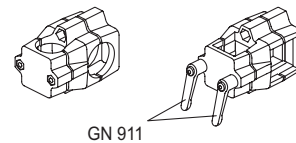

| Conversion Table | |
|-------------------|------|
| 1 mm = 0,039 inch | |
| d1 - d2 | |
| mm | inch |
| 30 | 1.18 |
| 40 | 1.57 |
| 48 | 1.89 |
| 50 | 1.97 |

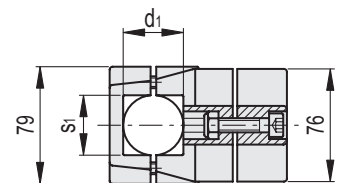
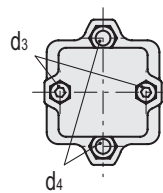
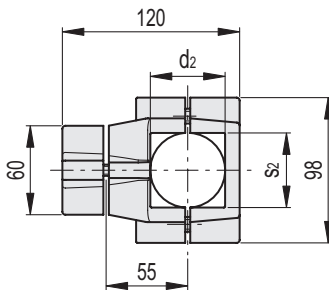

METRIC

GN 135-B-B

| Code | Description | d1 - d2 | d3 | d4 | d3 Clamping kit | d4 Clamping kit | ⚖️ |
|----------|------------------------|---------|----|-----|-----------------|-----------------|-----|
| GN.44557 | GN 135-B30-B40-60-2-BL | 30 - 40 | M8 | M10 | GN 911-M8-55 | GN 911-M10-55 | 928 |
| GN.44559 | GN 135-B30-B48-60-2-BL | 30 - 48 | M8 | M10 | GN 911-M8-55 | GN 911-M10-55 | 486 |
| GN.44561 | GN 135-B30-B50-60-2-BL | 30 - 50 | M8 | M10 | GN 911-M8-55 | GN 911-M10-55 | 860 |
| GN.44569 | GN 135-B40-B48-60-2-BL | 40 - 48 | M8 | M10 | GN 911-M8-55 | GN 911-M10-55 | 461 |
| GN.44571 | GN 135-B40-B50-60-2-BL | 40 - 50 | M8 | M10 | GN 911-M8-55 | GN 911-M10-55 | 454 |
| GN.44558 | GN 135-B30-B40-60-2-SW | 30 - 40 | M8 | M10 | GN 911-M8-55 | GN 911-M10-55 | 800 |
| GN.44560 | GN 135-B30-B48-60-2-SW | 30 - 48 | M8 | M10 | GN 911-M8-55 | GN 911-M10-55 | 735 |
| GN.44562 | GN 135-B30-B50-60-2-SW | 30 - 50 | M8 | M10 | GN 911-M8-55 | GN 911-M10-55 | 728 |
| GN.44570 | GN 135-B40-B48-60-2-SW | 40 - 48 | M8 | M10 | GN 911-M8-55 | GN 911-M10-55 | 710 |
| GN.44572 | GN 135-B40-B50-60-2-SW | 40 - 50 | M8 | M10 | GN 911-M8-55 | GN 911-M10-55 | 150 |

Tube connectors

| Conversion Table | |
|-------------------|------|
| 1 mm = 0.039 inch | |
| d1 - d2 -s1 - s2 | |
| mm | inch |
| 30 | 1.18 |
| 40 | 1.57 |
| 48 | 1.89 |
| 50 | 1.97 |

GN 135-B-V

| Code | Description | d1 - s2 | d3 | d4 | d3 | d4 | ⚖ |
|----------|------------------------|---------|----|-----|--------------|---------------|-----|
| | | | | | Clamping kit | Clamping kit | |
| GN.44564 | GN 135-B30-V40-60-2-BL | 30 - 40 | M8 | M10 | GN 911-M8-55 | GN 911-M10-55 | 905 |
| GN.44566 | GN 135-B30-V50-60-2-BL | 30 - 50 | M8 | M10 | GN 911-M8-55 | GN 911-M10-55 | 880 |
| GN.44574 | GN 135-B40-V50-60-2-BL | 40 - 50 | M8 | M10 | GN 911-M8-55 | GN 911-M10-55 | 800 |
| GN.44565 | GN 135-B30-V40-60-2-SW | 30 - 40 | M8 | M10 | GN 911-M8-55 | GN 911-M10-55 | 960 |
| GN.44567 | GN 135-B30-V50-60-2-SW | 30 - 50 | M8 | M10 | GN 911-M8-55 | GN 911-M10-55 | 50 |
| GN.44575 | GN 135-B40-V50-60-2-SW | 40 - 50 | M8 | M10 | GN 911-M8-55 | GN 911-M10-55 | 500 |

METRIC

GN 135-V-V

| Code | Description | s1 - s2 | d3 | d4 | d3 | d4 | ⚖ |
|----------|------------------------|---------|----|-----|--------------|---------------|-----|
| | | | | | Clamping kit | Clamping kit | |
| GN.44586 | GN 135-V30-V40-60-2-BL | 30 - 40 | M8 | M10 | GN 911-M8-55 | GN 911-M10-55 | 886 |
| GN.44588 | GN 135-V30-V50-60-2-BL | 30 - 50 | M8 | M10 | GN 911-M8-55 | GN 911-M10-55 | 750 |
| GN.44596 | GN 135-V40-V50-60-2-BL | 40 - 50 | M8 | M10 | GN 911-M8-55 | GN 911-M10-55 | 760 |
| GN.44587 | GN 135-V30-V40-60-2-SW | 30 - 40 | M8 | M10 | GN 911-M8-55 | GN 911-M10-55 | 800 |
| GN.44589 | GN 135-V30-V50-60-2-SW | 30 - 50 | M8 | M10 | GN 911-M8-55 | GN 911-M10-55 | 704 |
| GN.44597 | GN 135-V40-V50-60-2-SW | 40 - 50 | M8 | M10 | GN 911-M8-55 | GN 911-M10-55 | 783 |

METRIC

GN 135-V-B

| Code | Description | s1 - d2 | d3 | d4 | d3 | d4 | ⚖ |
|----------|------------------------|---------|----|-----|--------------|---------------|-----|
| | | | | | Clamping kit | Clamping kit | |
| GN.44579 | GN 135-V30-B40-60-2-BL | 30 - 40 | M8 | M10 | GN 911-M8-55 | GN 911-M10-55 | 911 |
| GN.44581 | GN 135-V30-B48-60-2-BL | 30 - 48 | M8 | M10 | GN 911-M8-55 | GN 911-M10-55 | 874 |
| GN.44583 | GN 135-V30-B50-60-2-BL | 30 - 50 | M8 | M10 | GN 911-M8-55 | GN 911-M10-55 | 150 |
| GN.44591 | GN 135-V40-B48-60-2-BL | 40 - 48 | M8 | M10 | GN 911-M8-55 | GN 911-M10-55 | 447 |
| GN.44593 | GN 135-V40-B50-60-2-BL | 40 - 50 | M8 | M10 | GN 911-M8-55 | GN 911-M10-55 | 830 |
| GN.44580 | GN 135-V30-B40-60-2-SW | 30 - 40 | M8 | M10 | GN 911-M8-55 | GN 911-M10-55 | 747 |
| GN.44582 | GN 135-V30-B48-60-2-SW | 30 - 48 | M8 | M10 | GN 911-M8-55 | GN 911-M10-55 | 728 |
| GN.44584 | GN 135-V30-B50-60-2-SW | 30 - 50 | M8 | M10 | GN 911-M8-55 | GN 911-M10-55 | 721 |
| GN.44592 | GN 135-V40-B48-60-2-SW | 40 - 48 | M8 | M10 | GN 911-M8-55 | GN 911-M10-55 | 160 |
| GN.44594 | GN 135-V40-B50-60-2-SW | 40 - 50 | M8 | M10 | GN 911-M8-55 | GN 911-M10-55 | 689 |

METRIC

